



BUTLER & STAG
TO LET
01992 667666

OAKLEY COURT

Hillyfields, Loughton, IG10

BUTLER & STAG



A fully refurbished, neat, functional & self-contained studio apartment with its own private entrance in a peaceful residential cul-de-sac.



- Studio Apartment
- Recently Refurbished
- Private Entrance
- Close to Tube
- Unfurnished
- Available Now

A fully refurbished, neat, functional & self-contained studio apartment with its own private entrance in a peaceful residential cul-de-sac.

Very secure and perfect for a single person wanting their own space.

Oakley Court is ideally situated for Debden Broadway and Loughton both with Central Line Stations both are equally close by. Loughton is a particularly sought after area due to its schools, transport links and shops, with Epping Forest on the doorstep. The Central Line gives easy access to the City, Canary Wharf and West End, and for road users, the M25, M11 and routes into London are conveniently close by.

Available May, unfurnished.



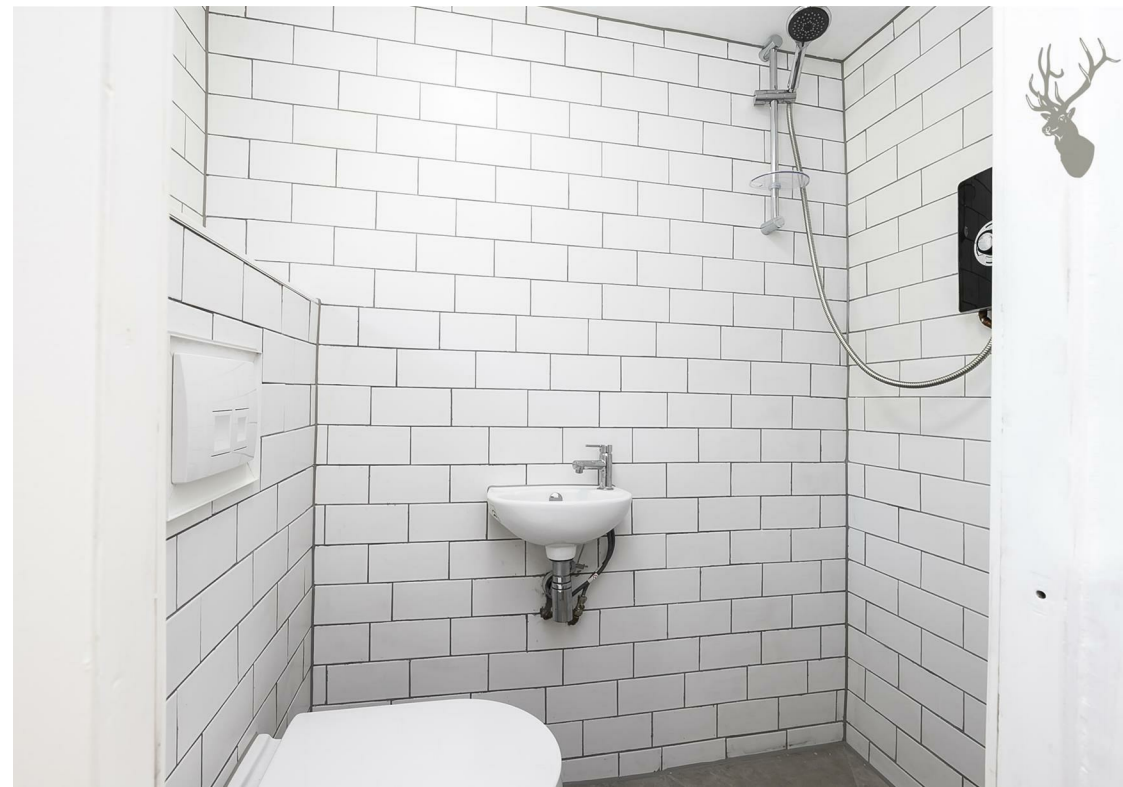

Oakley Court, Hillyfields

Ground Floor

Approx. 25 Sq. meters (264 Sq. feet)

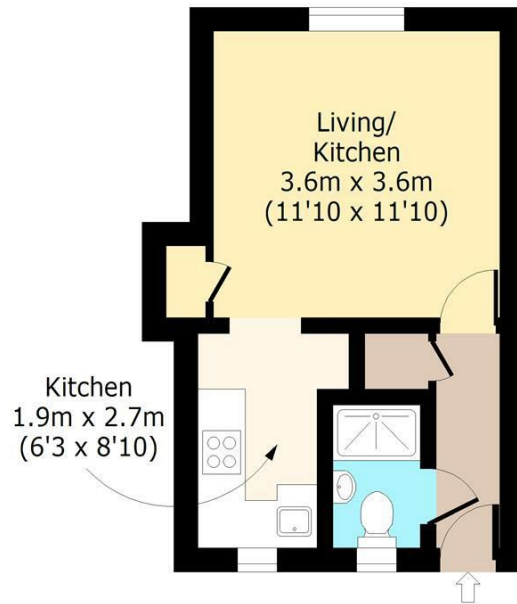

Total area: approx. 25 Sq. meters (264 Sq. feet)
For illustration purposes only - not to scale
www.lpaplus.com

BUTLER & STAG

☎ 01992 667666

🏠 4 Forest Drive, Theydon Bois, Essex, CM16 7EY

✉ theydon@butlerandstag.com

www.butlerandstag.uk

IMPORTANT NOTICE - These particulars have been prepared in good faith and they are not intended to constitute part of an offer or contract. We have not performed a structural survey on this property and the services, appliances and specific fittings have not been tested. All photographs, measurements, floor plans and distances referred to are given as a guide and should not be relied upon.